

KUPLAT 480

Asennusohje
V.14A

INNOLUX
design Yki Nummi

Osat:

1 x Kupu

Ripustussarjan tarvikkeet:

1 x Valaisinjohto 

1 x Valaisinpistotulppajohto 

1 x Messingin värinen kartiokuppi 

1 x Kattokuppi 

1 x Ripustuskoukku 

1 x Musta tiiviste, riviliitin 

1 x Ruuvimeisseli 

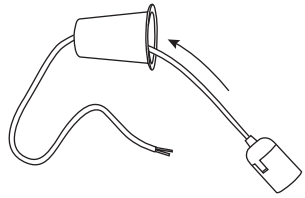

1 Pujota valaisinjohto kartiokupin läpi.

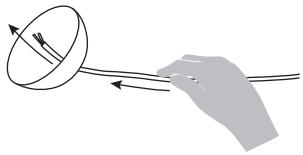

3 Pujota valaisinjohto kattokupin läpi.

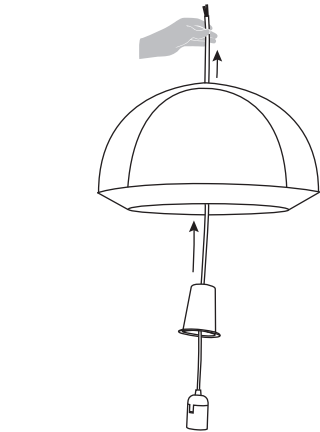

2 Pujota valaisinjohto kuvun läpi alakautta.

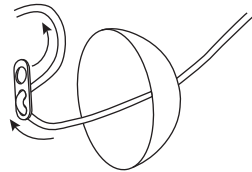

4 Pujota ripustuskoukku valaisinjohtoon.

INNOLUX
Home of good light.

A Kattopistorasia:

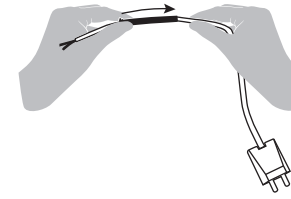

5 Pujota valaisinpistotulpan johto mustan tiivistein läpi.

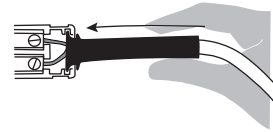

7 Siirrä musta tiiviste paikalleen.

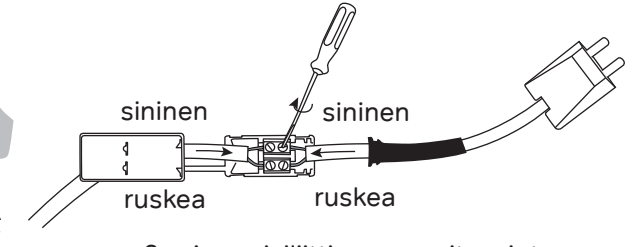

6 Avaa riviliittimen ruuvit, pujota molempien johtojen päät paikoilleen riviliittimeen ja kiristä ruuvit.

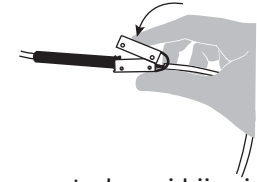

8 Napsauta kansi kiinni, varmista että kaikki neljä hakasta kiinnittyvät.

B Ei kattopistorasiaa:

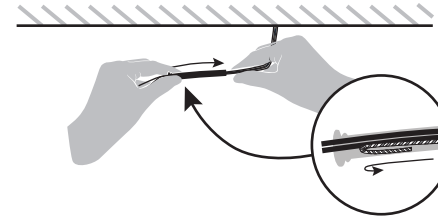

5 Taita keltavihreä katosta tuleva johto kaksinkerroin ja pujota kaikki katosta tulevat johtimet tiivistein läpi.

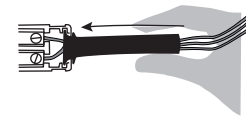

7 Siirrä musta tiiviste paikalleen.

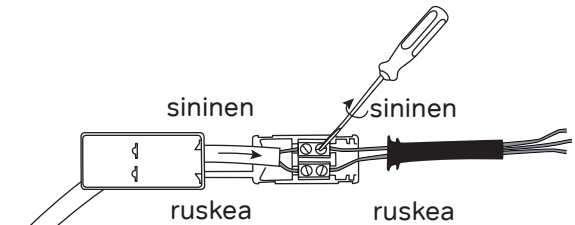

6 Avaa riviliittimen ruuvit, pujota valaisinjohtoon sekä katosta tulevien johtimien päät riviliittimeen ja kiristä ruuvit.

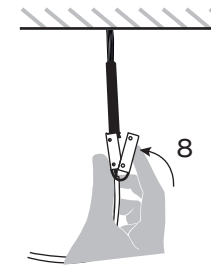

8 Napsauta kansi kiinni, varmista että kaikki neljä hakasta kiinnittyvät.

(A) Kattopistorasia:

1

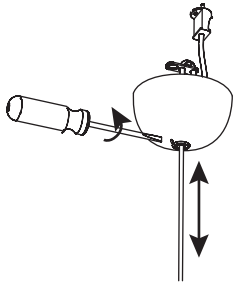

2

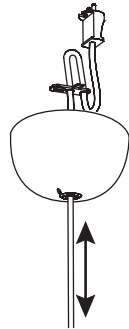

3

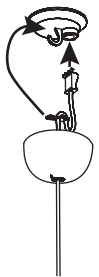

4

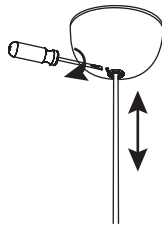

(B) Ei kattopistorasiaa:

1

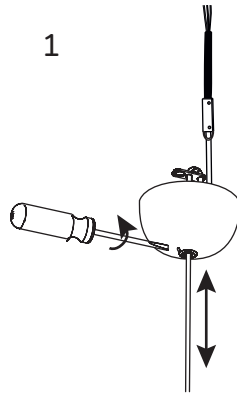

2

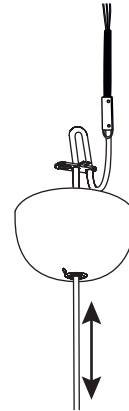

3

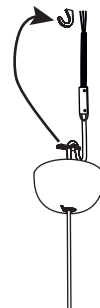

4

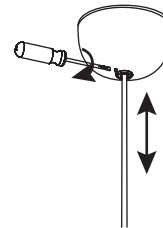

KUPLAT 480 (BUBBLES)

Installation instructions
V.14A

Parts:

1 x Lampshade

Suspension set supplies:

1 x Cord 

1 x Ceiling plug cord 

1 x Brass cone-shaped cup 

1 x Ceiling-rose 

1 x Cord-strain 

1 x Rubber sleeve, two poles terminal block 

1 x Screwdriver 

INNOLUX
design Yki Nummi

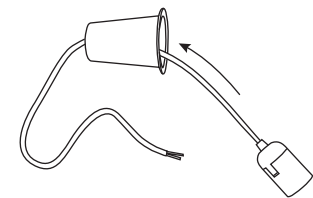

1 Thread the cord through the cone-shaped cup.

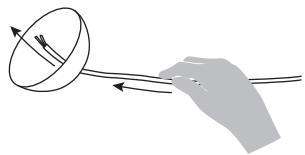

3 Thread the cord through the ceiling-rose.



2 Thread the cord through the lampshade from underneath.

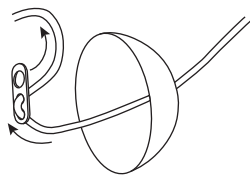

4 Insert cord-strain to the cord.

INNOLUX
Home of good light.

A Roof socket:

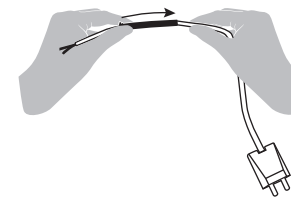

5 Insert the ceiling plug cord through the rubber sleeve.

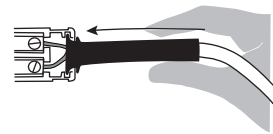

7 Move the rubber sleeve to its place.

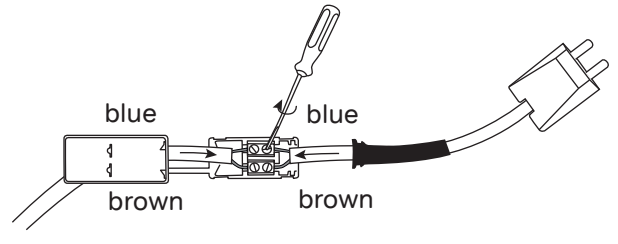

6 Open the screws of two poles terminal block, insert the ends of the cords in their places and tighten the screws firmly.

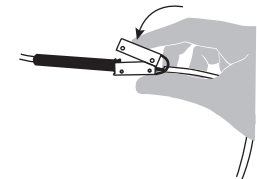

8 Close the cover so that all four staples click.

B No roof socket:

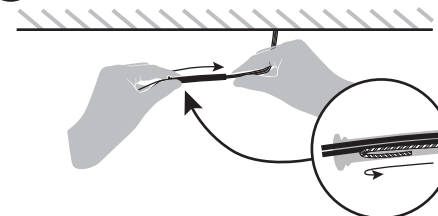

5 Fold the yellowgreen ceiling wire and insert all the ceiling wires through the rubber sleeve.

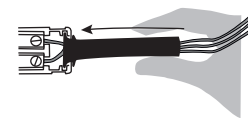

7 Move the rubber sleeve to its place.

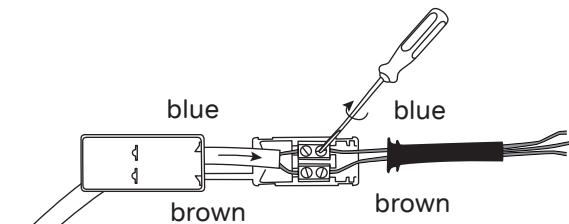

6 Open the screws of two poles terminal block, insert the ends of the cord and the ceiling wires (not the yellowgreen wire) in their places and tighten the screws firmly.

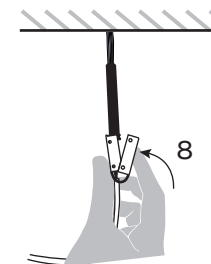

8 Close the cover so that all four staples click.

(A) Roof socket:

1

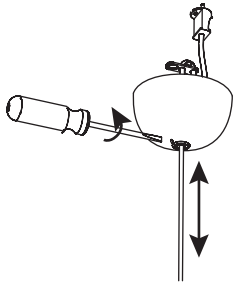

2

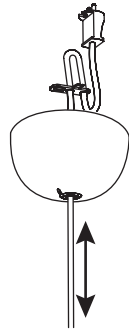

3

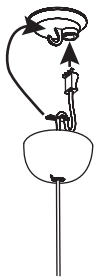

4

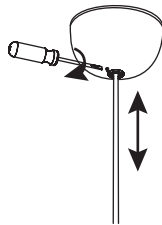

(B) No roof socket:

1

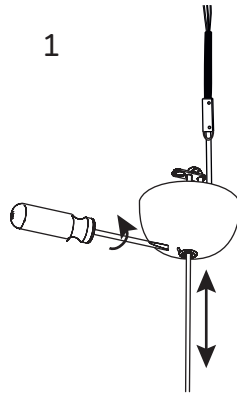

2

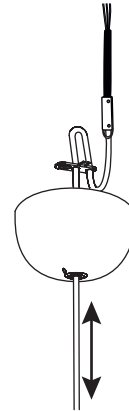

3

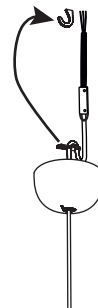

4

